

Northbrook 4th of July Association

P.O. Box 474 Northbrook, Illinois 60065

PARADE ENTRY CONFIRMATION

June 2012

Theme: "Imagine"

POSITION NUMBER

60

Welcome to Northbrook's 4th of July Parade!

Parade staging will be from 1:30 to 2:00. All units wishing to be judged must be in place no later than 2:10. The parade steps off at 2:30.

Enclosed is a parade map. As noted on the map all floats, vehicles, and musical units should enter the staging area from Pfingsten Road turning eastbound onto Cherry. Participants strictly walking the parade route should be dropped off on Shannon Road.

The Northbrook 4th of July Association respectfully requests your cooperation in the following matters:

- Please observe the parade policies developed by the Association. These are in place to help ensure a pleasant and safe experience for all. A copy is enclosed.
- Please be cautious when handing out items: to prevent children from running into the street, make your distribution at the curbside. Please be sensitive to allergic individuals when choosing food items; avoiding tree nut and peanut ingredients.
- Unit identification numbers will be posted at your parade position in the staging area. These numbers are to be affixed to some feature in your entry, (please bring your own materials, such as tape or string) preferably on both sides, so that the audience can identify you from a program, as well as for any broadcasting commentary. Un-numbered entries will not be eligible for awards.
- Police personnel stationed at the end of the parade will direct marchers to disband on the Village Green. Floats may dismantle in the Commuter Parking lot (on the map; locations 2 and 3).

Thank you for participating in the Parade!

Questions may be directed to the following committee members:

Specialty Units and Bands: Karen Kitzes 847-564-1715

Parade Entries/Position: Jody Kenzer 847-772-6550



The Northbrook 4th of July Association

PARADE MAP

Musical Units/Parade Contacts
Karen Kitzes 847-564-1715
Jody Kenzer 847-772-6550

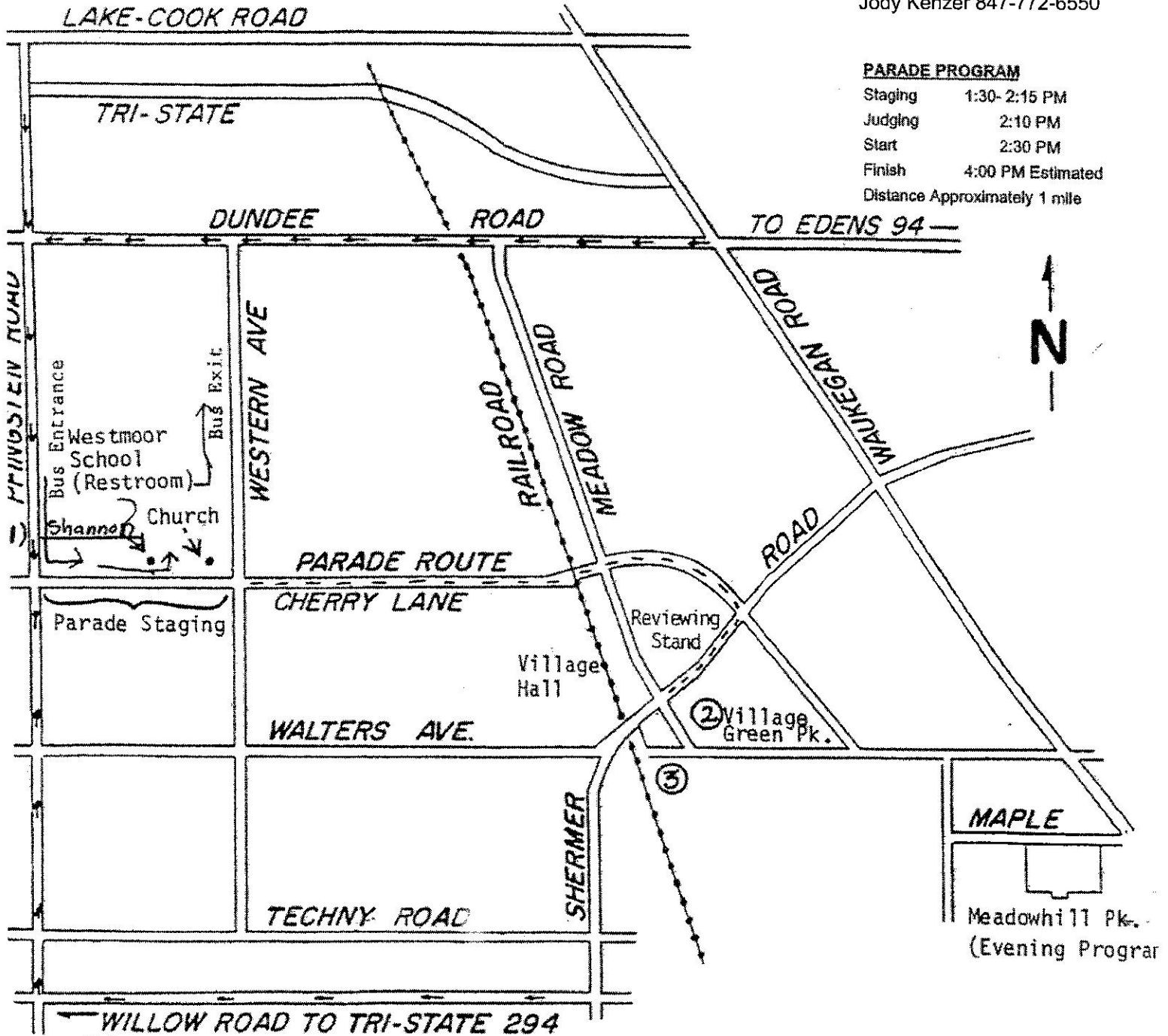

PARADE PROGRAM

Staging	1:30- 2:15 PM
Judging	2:10 PM
Start	2:30 PM
Finish	4:00 PM Estimated
Distance Approximately 1 mile	

Parade Participant Drop-Off Point

1) To ensure the safety of all parade participants and reduce traffic congestion, please drop-off individuals who are part of parade entry (marching group, etc) on Shannon Rd. Enter Shannon from Pflingsten going east and drop off just north of Westmoor School between Candlewood Hill Dr. and Adelaide Dr). Participants and walk through the Westmoor grounds to Cherry Lane the staging area.

SPECIAL INSTRUCTIONS:

Police personnel will direct end of parade traffic:
 (3) Bus Parking/Loading
 (2) Marchers Disband
 (3) Floats Dismantle